

TALLED

Smart Solar Light

Wiring Free / No Cost / Intelligent Light Dimmer

STREET LIGHT
INTEGRATED
All in one



TALLED
LED Provided by Samsung

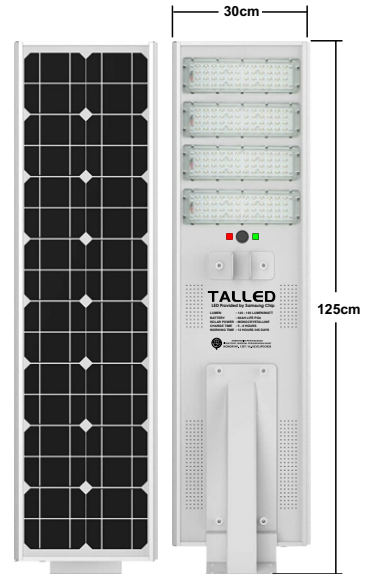

- 
Light Sensor
 - 
Lighting Protection
 - 
Waterproof
 - 
Wiring Free
- Sunlight control and Motion sensor**



KEMENTERIAN PERHUBUNGAN
DIREKTORAT JENDERAL PERHUBUNGAN DARAT
NOMOR KP. 1287 / AJ.033/DJPD/2020

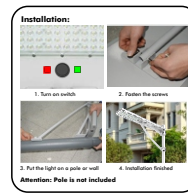
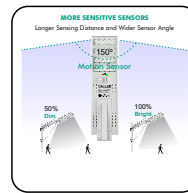

- POWER** : **200W**
- LED** : **SAMSUNG CHIP 2835-200PCS**
- LUMEN** : **140 - 160 LUMEN/WATT**
- SOLAR POWER** : **85 WP MONOCRYSTALLINE**
- CCT** : **6000 - 6500K**
- BATTERY** : **60AH LiFePo4**
- SENSOR** : **MOTION SENSOR AVAILABLE**
- BEAM ANGLE** : **70° * 150°**
- CHARGE TIME** : **5 - 8 HOURS**
- WORKING TIME** : **12 HOURS 365 DAYS**
- MOUNTING LIGHT** : **4 - 9 METERS**
- SPACE BETWEEN LIGHT** : **15 - 25 METERS**
- HOUSING** : **ALUMINUM**
- WARRANTY** : **2 YEARS**
- WEIGHT (G.W)** : **±14KG**
- SIZE** : **1250*300*50mm**

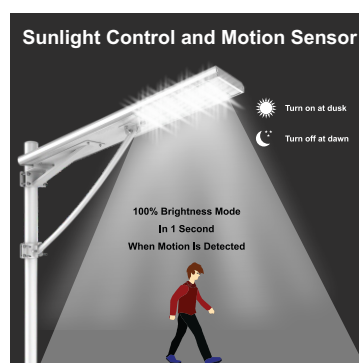
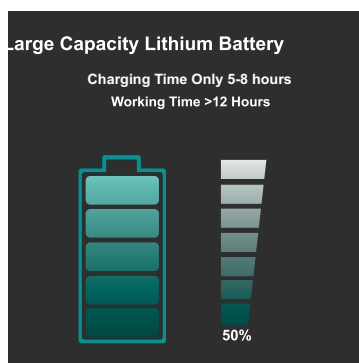
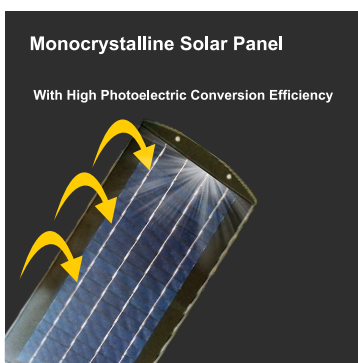

All In One LED Solar Street Light installation manual

All in one solar street lamp installation instructions

Picture							
	Power	60W	80W	100W	120W	150W	200W
	Voltage	DC12V					
	CCT	6000K-6500K					
	LED Chip	Samsung2835					
	Lumen:	140-150lm/watt					
	Control system	Turn on/off Automatically+Remote control					
	Solar panel	monocrystalline					
	Battery	32650lithium iron phosphate battery 60AH					
	Beam angle:	70-150°					
	Charge Time:	5-8H					
	Working time:	12H 365 DAYS					
	Mounting High:	4-9 Meters					
	Housing:	Aluminum material					
	Space between light	15-25 meters					

Installation method

(1) Select the best day-lighting location to set up the pole. Pole 3-7 meters high is appropriate, diameter 40 ~ 100mm, Thickness more than 2.0mm iron rod or steel rod.

(2) Open the packaging and check if components are completed. Contained components as follows

(3) Turn on the switch before installation

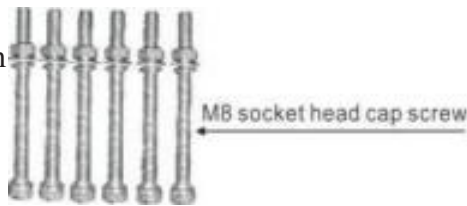

(4) Put the integrated solar lamp into the lamp pole and tighten the screw with a special tool to ensure the lamp holder.

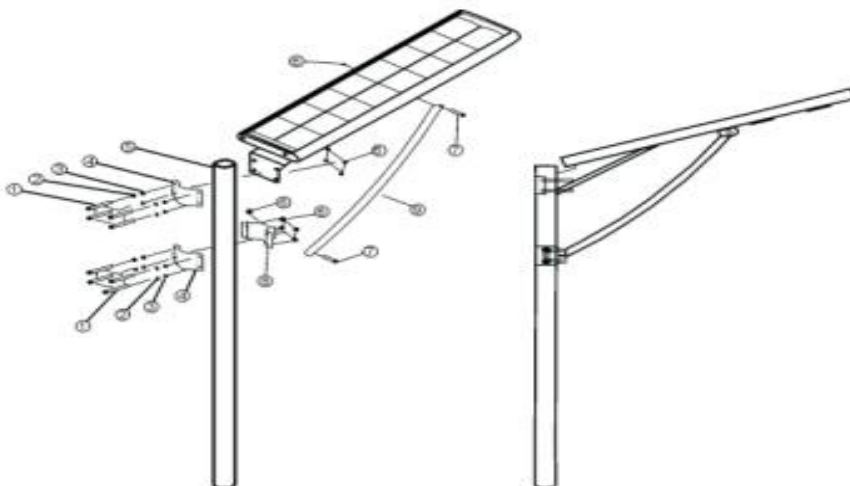

Directory

- (1) The all-in-one solar light can't work without sunshine. Please select a matching product. The model depends on the installation position or the sum of sunshine intensity Annual solar radiation. In areas with insufficient sunshine or long continuous rainy days, the working time of the solar lamp can be shortened or cannot be illuminated. In this case, it is recommended to choose the integrated lamp or solar dual-mode power supply with municipal power supply.
- (2) long life lithium battery is selected as energy storage equipment. The discharge condition at night is $-20\text{ }^{\circ}\text{C} - +60\text{ }^{\circ}\text{C}$, beyond which the battery performance will be damaged. When selecting "all in one machine", please make sure that the local extreme temperature does not exceed the above conditions.
- (3) After the battery of "all in one" is fully charged, the maximum storage time can be up to 6 months. After long-term transportation or storage, the battery shall be checked in time, charged regularly and recorded. Otherwise, the battery will be damaged.
- (4) In the installation of "All in one solar light", make the solar panel face to the sun as much as possible in order to obtain the maximum energy and avoid the shadow of houses and obstacles such as trees, otherwise, the power generation efficiency of the solar panel will be reduced and the "integration" working time will be shortened.
- (5) The cleanliness of the surface of the "all in one" solar panel also affects the power generation efficiency of the solar panel. Therefore, its surface (such as dust, leaves, oil, etc.) needs to be cleaned. It is recommended to use regular cleaning agent to scrub.
- (6) The "all in one" internals have good waterproof design, all of which meet the IP65 standard. Vents and cracks in the enclosure are designed specifically for cooling and drainage. The metal parts are made of corrosion-resistant aluminum or stainless steel, which can adapt to the strict environment such as sea water or high temperature and high humidity desert.

Troubleshooting

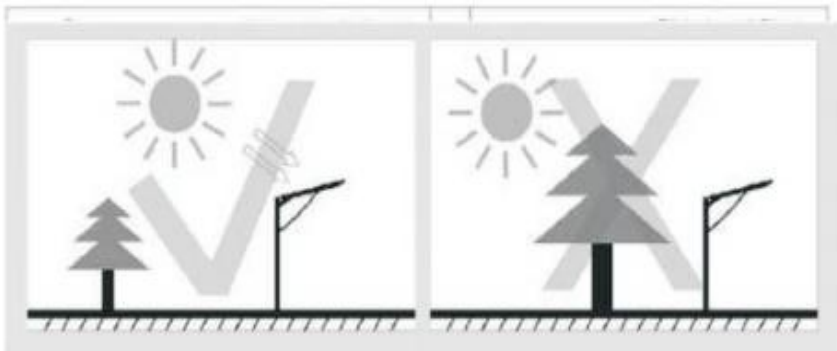

★ When install the All in one solar led street, please choose a position with enough sunshine and fully exposure. Please note the solar panel must be fully exposed, without any shelter.

Maintenance

- (1) The solar controller is the core part of the solar street lamp, with light control, time control, charge and discharge functions. Keep dry and do not touch the button. Must be used in professional operations
- (2) Solar panels are the components with the longest service life in solar street lamps, which can last 20-25 years. During use, if it doesn't rain for a few days, large amounts of soil dust will accumulate on the surface of the solar panels, which will affect the efficiency of power generation. If the solar panel is placed towards the south, correct it in time if it swings;
- (3) LED light source has a long service life, and the general failure rate is very low. After 2-3 years of use, it is necessary to clean the whole light source to avoid dirt blocking electricity and reducing the brightness of the light;
- (4) The battery itself has a certain capacity of self-discharge. When the integrated solar lamp is not used for a long time, please take out the lamp regularly and charge it in the sun.